

# Grand Award Judges' Parking Guide and Maps

## Colorado Science & Engineering Fair (CSEF)

### April 5, 2018

**FREE Off-Campus Parking and Shuttle to Campus:** Due to the limited amount of on-campus parking and the increased cost of a visitor parking permit, CSEF has arranged for off-campus parking and a **free shuttle** to take people to/from the Lory Student Center (LSC) on **Thursday, April 5<sup>th</sup> ONLY**. Free parking will be guaranteed at the **CSU Equine Center on Overland Trail from 7 a.m. - 6:30 p.m.**

**DROP OFF & PICK UP:** The CSEF Shuttle Buses from the Equine Center will be dropping people off in front of the Administration Building on the Oval and NOT at the Transit Center. The Administration Building is located East of the Lory Student Center. To reach the student center, you will take Isotope Drive (between Wagar and Statistics buildings) West, past the Engineering Building (if the weather is bad, you can enter the Engineering building and walk inside all the way to the student center) to the Lory Student Center.

**TO THE THEATER:** The theater is on the main (2<sup>nd</sup>) floor and the best entrance is the main doors kind of in the middle of the building on the East side. Once inside, take the main hallway to the left (it is past the Information Desk) then the theater is on the branch off to the right.

For those of you coming from off-campus locations, there is construction going on throughout the CSU campus. Please make sure that you allow plenty of time to get to the Equine Center or LSC and check parking maps on the CSU web site before you come, for updates. For a map of the whole campus, please go to <http://ptsdata.colostate.edu/maps/mapside.pdf>.

As long as there are no unexpected road closures, you can follow these directions to reach the Equine Center on Overland Trail:

**From I-25 South & North of Fort Collins:** Take Exit 268 (Prospect Road) west to Overland Trail. Turn North (right) onto Overland Trail to just past Elizabeth Street. The Equine Center will be to the West (left) immediately after Elizabeth. **Please use the North entrance gate between 7 a.m. and 12 noon and park in the north side of the parking lot so as not to interfere with rodeo traffic that is also arriving on Thursday.**

**Grand Award Judges:** CSU shuttle buses will run between the Equine Center and the LSC Transit Center on **Thursday between 7 a.m. and 6:30 p.m. roughly every half hour** (please note that only ONE bus will run between 11 a.m. and 5 p.m.). When you arrive at the LSC, the **Grand Award Judges' Check-In** is **inside the LSC Theater** (see attached 200 level map).

**Category Team Captains:** **DO NOT use the Shuttle Service!** For all non-CSU faculty and students serving as a Grand Award Judge Team Captain, you have been provided a one-time campus parking permit since you will need to stay until ~8:30 p.m. We suggest you use the Library parking lot (#425 - see attached map/directions), as you will be arriving earlier than everyone else.

**Category Assistant Team Captains:** Please remember to allow plenty of time for parking and taking the shuttle to campus in order to attend the 9:15 a.m. Captain/Assistant Captains' Briefing.

On-Campus Parking Options: For those who want or need to park on campus Thursday for judging or who are visiting campus to take part of CSEF activities on Friday, you will be on your own for parking.

- Daily parking permits may be purchased from Parking Services in the Lake & Center Parking Garage (see above link for a detailed map). The cost is **\$12/day**. You must have your vehicle's make, model, year, and license plate number when you purchase a permit.
- Most lots have hourly metered parking spots during permit hours (most lots are enforced 7:30 a.m. to 4 p.m. daily). **Meter costs are \$1.75/hour and machines only accept credit cards for payment.** Check the signs posted in each lot for enforcement times; some lots have extended enforcement hours. The lots that have time limits of up to 8 ½ hours include #195 (Moby), #310 (Engineering), #425 (Morgan Library), #570 (Lake Street Garage), #577 (South College Garage), #725 (Vet Teaching Hospital) & #740 (Tennis Pavilion).
- The parking lots that are closest to the LSC (but fill up fast!) are Lot #310 (Engineering) and Lot #425 (Morgan Library).
- \*\*\*NEW for 2018\*\*\* **ALL** vehicles, even those with state or federal plates require a parking permit.
- Parking for people with a valid handicapped permit may park in any of the marked handicapped stalls, but must have a CSU parking permit or pay the meters, if applicable.
- CARPOOL!! CARPOOL!!
- Around the Horn is a free-on-campus shuttle that connects to most visitor parking lots with a bus that loops campus every 10 minutes from 7 a.m. to 6:40 p.m. Monday through Friday. ([www.ridetransfort.com/img/site\\_specific/uploads/HORN.pdf](http://www.ridetransfort.com/img/site_specific/uploads/HORN.pdf))
- The parking lots that have visitor parking available and are connected to Around the Horn are: Lot #195 (Moby); Lot #440 (University Station); Lot #570 (Lake Street Garage); Lot #725 (Vet Teaching Hospital); and Lot #740 (Tennis Pavilion).
- BE AWARE that even if you purchase a parking permit, CSU does not guarantee a parking space.

CSEF is **NOT** responsible for parking citations issued by CSU to CSEF finalists, their parents, teachers or any of the judges and volunteers. Parking information and costs provided herein are subject to change by CSU at any time, so please read and follow the instructions on posted signs in the CSU parking lots.

# Shuttle Drop-off Map

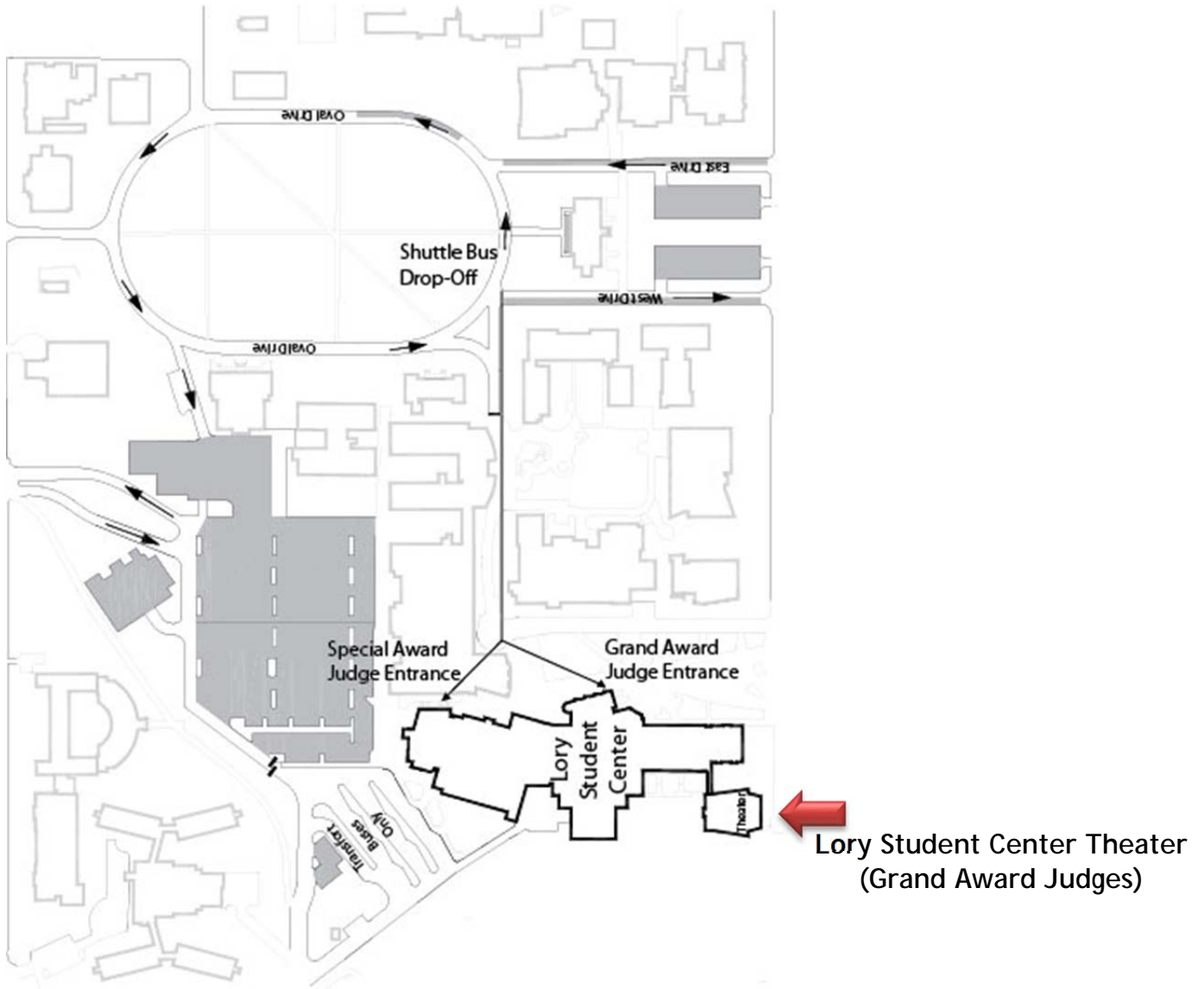

# Equine Center Parking Map

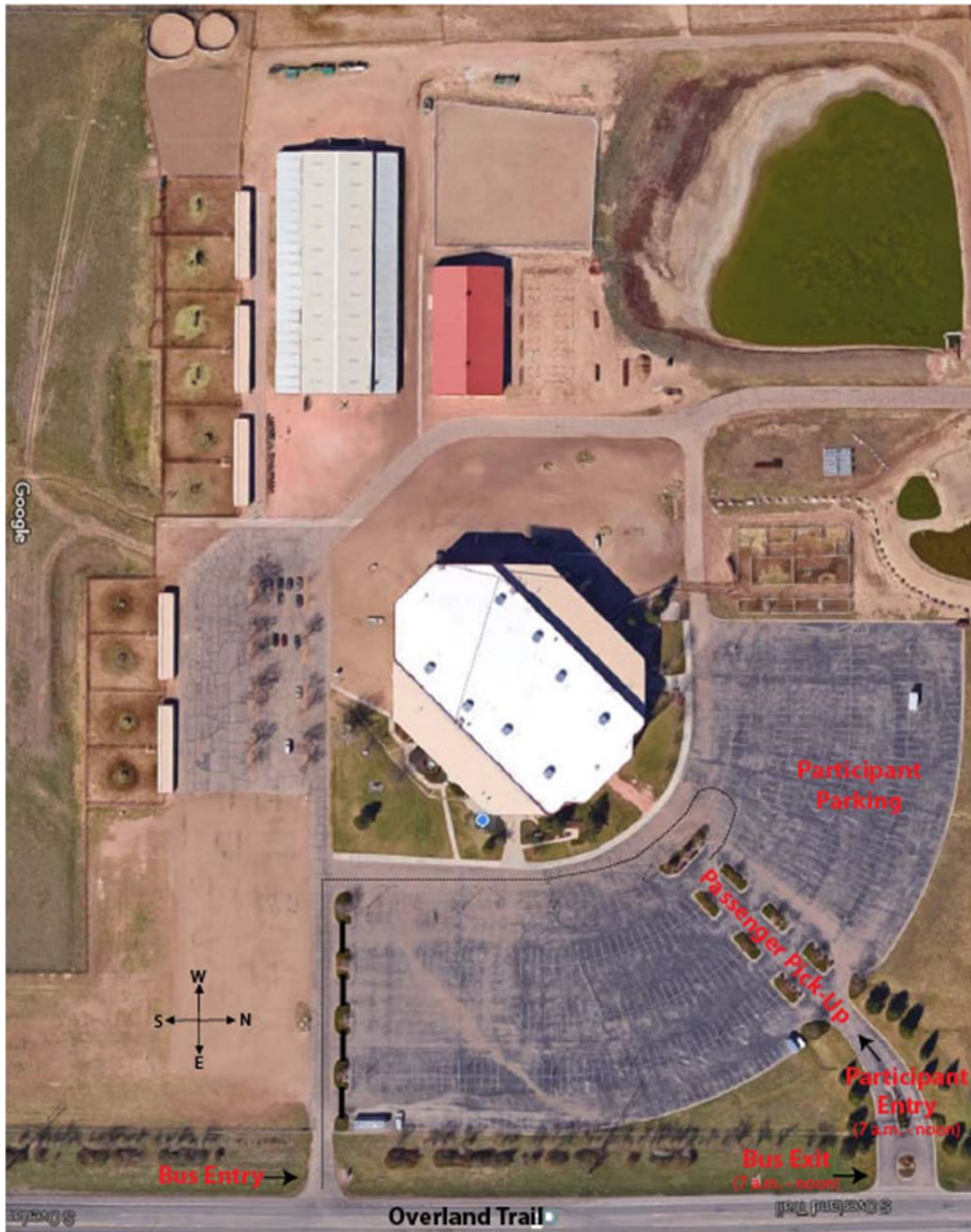



Restrooms	
AED Location	
Elevator	

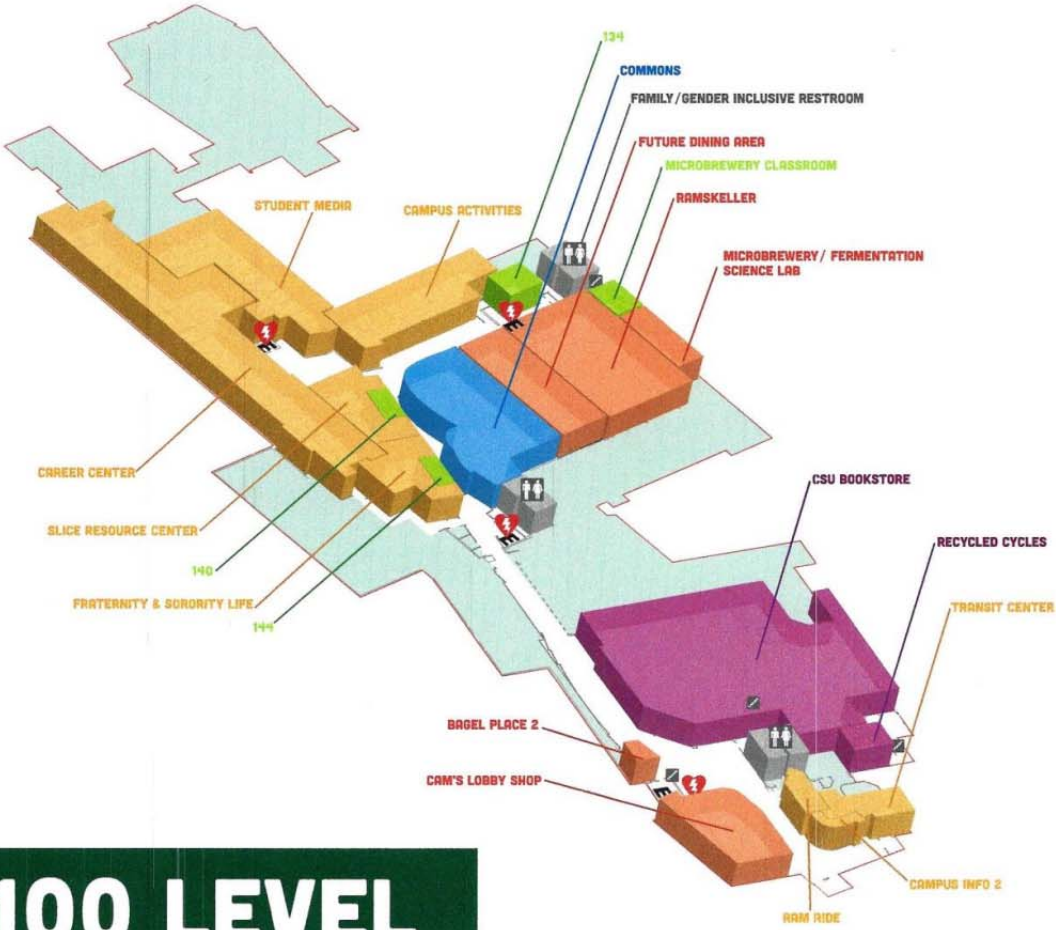

# 100 LEVEL

## Play

150 COMMONS

## Shop

175 CSU BOOKSTORE  
197 RECYCLED CYCLES

## Eat

151 FUTURE DINING AREA  
152 RAMSKELLER  
152B MICROBREWERY / FERMENTATION SCIENCE LAB  
176 BAGEL PLACE 2  
178 CAM'S LOBBY SHOP

## Services

110 STUDENT MEDIA  
120 CAREER CENTER  
130 CAMPUS ACTIVITIES  
141 SLICE RESOURCE CENTER  
142 FRATERNITY & SORORITY LIFE  
191 RAM RIDE  
196 TRANSIT CENTER  
198E CAMPUS INFO 2

## Gather

134 MEETING ROOM  
140 MEETING ROOM  
144 MEETING ROOM  
152A MICROBREWERY CLASSROOM

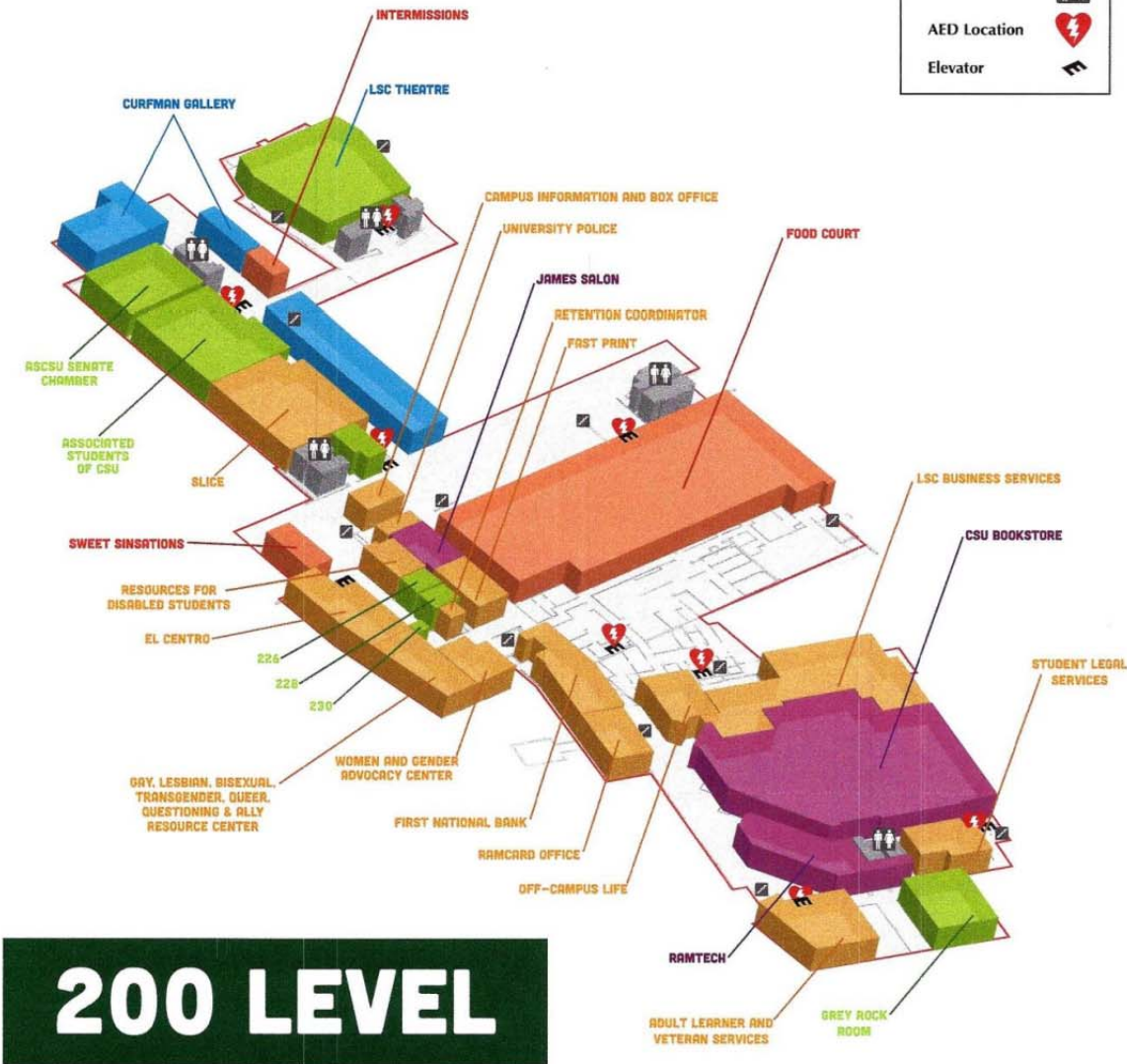
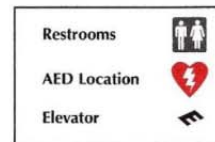

# 200 LEVEL

## Play

- 200 CURFMAN GALLERY
- 207 SUNKEN LOUNGE

## Shop

- 241 JAMES SALON
- 279 CSU BOOKSTORE
- 280 RAMTECH

## Eat

- 203 INTERMISSIONS
- 222 SWEET SINSATIONS
- 252 FOOD COURT

## Gather

- TH201 LSC THEATRE
- 204 ASCSU SENATE CHAMBERS
- 206 ASSOCIATED STUDENTS OF CSU
- 212 MEETING ROOM
- 226 MEETING ROOM
- 228 MEETING ROOM
- 230 STUDY ROOM
- 290 GREY ROCK ROOM

## Services

- 210 SLICE
- 240 CAMPUS INFORMATION AND BOX OFFICE
- 242 UNIVERSITY POLICE
- 223 RESOURCES FOR DISABLED STUDENTS
- 246 FAST PRINT
- 225 EL CENTRO
- 231 RETENTION COORDINATOR
- 232 GAY, LESBIAN, BISEXUAL, TRANSGENDER, QUEER, QUESTIONING & ALLY RESOURCE CENTER
- 234 WOMEN AND GENDER ADVOCACY CENTER
- 271 FIRST NATIONAL BANK
- 271 RAMCARD OFFICE
- 274 OFF-CAMPUS LIFE
- 276 LSC BUSINESS SERVICES
- 288 ADULT LEARNER AND VETERAN SERVICES
- 284 STUDENT LEGAL SERVICES

Restrooms	
AED Location	
Elevator	
Lactation room	

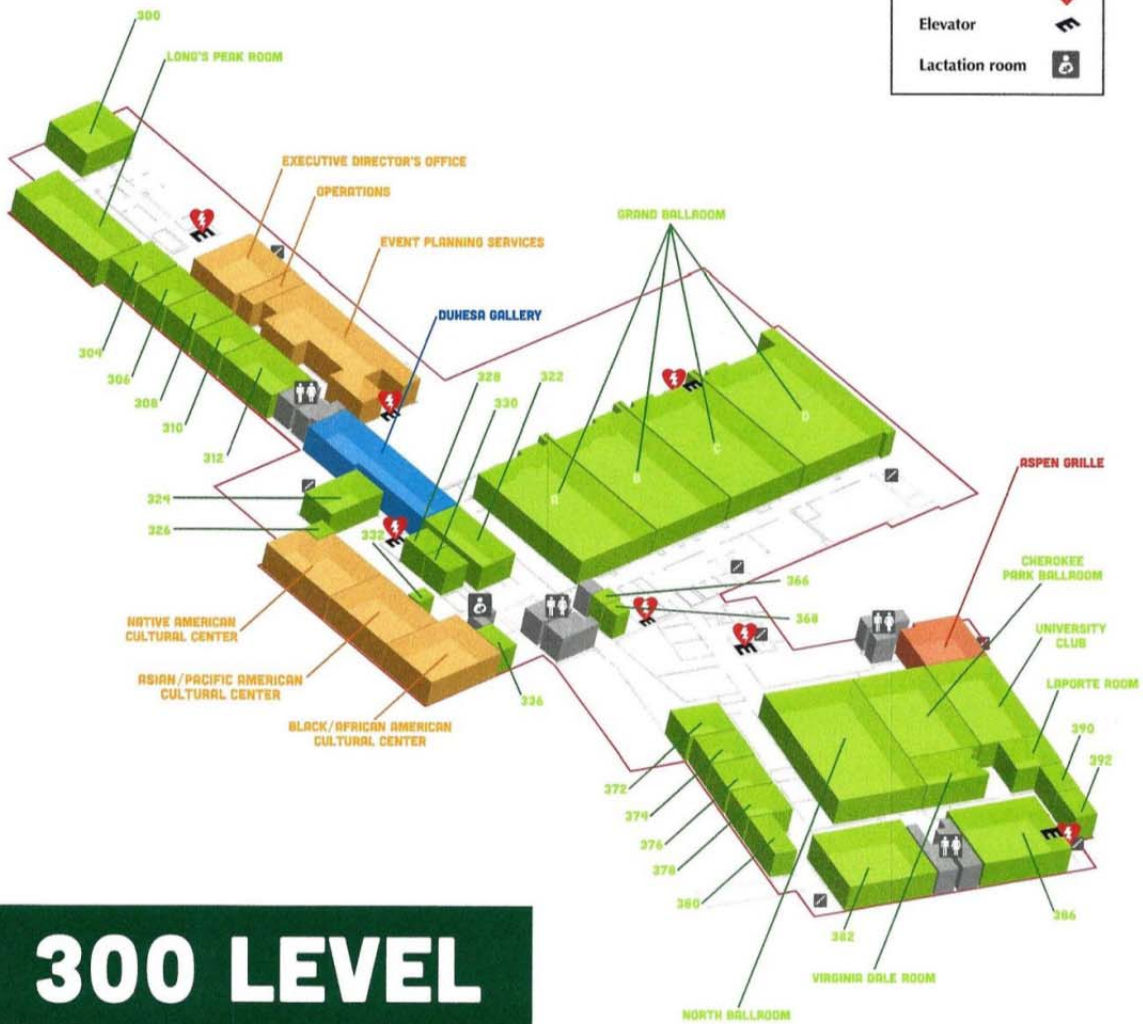

# 300 LEVEL

## Play

320 DUHESA GALLERY

## Eat

388E ASPEN GRILLE

## Services

303 EXECUTIVE DIRECTOR'S OFFICES  
 309 OPERATIONS  
 315 EVENT PLANNING  
 327 NATIVE AMERICAN CULTURAL CENTER  
 333 ASIAN/PACIFIC AMERICAN CULTURAL CENTER  
 336 BLACK/AFRICAN AMERICAN CULTURAL CENTER

## Gather

300 MEETING ROOM  
 302 LONG'S PEAK ROOM  
 304 MEETING ROOM  
 306 MEETING ROOM  
 308 MEETING ROOM  
 310 MEETING ROOM  
 312 MEETING ROOM  
 322 MEETING ROOM  
 324 MEETING ROOM  
 326, 328, 336 STUDY ROOMS  
 328 MEETING ROOM  
 330 MEETING ROOM  
 350A-D GRAND BALLROOM  
 366, 368 REFLECTION ROOMS  
 372 MEETING ROOM  
 374 MEETING ROOM  
 376 MEETING ROOM  
 378 MEETING ROOM  
 380 MEETING ROOM  
 382 MEETING ROOM  
 384 NORTH BALLROOM  
 386 MEETING ROOM  
 388A VIRGINIA DALE ROOM  
 388B LAPORTE ROOM  
 388C UNIVERSITY CLUB  
 388D CHEROKEE PARK BALLROOM



